

## Accessoires en acier inoxydable



## Matériaux et composants

Les accessoires de raccordement sont en acier inoxydable AISI 316 Ti (ou 316).

Tous les filetages femelles sont :

- cylindriques BSP

Les filetages mâles sont :

- coniques BSP (ISO 7/1)

- cylindriques BSP avec joint Viton (ISO 228)



**Champ d'application :**

**industrie chimique et alimentaire**

pression maximale d'exercice :

50 BAR (température ambiante)

température de travail :

- 20°C / + 200°C (limites du joint Viton)

## Accessoires en acier inoxydable

### 220 X



inox  
316 Ti

#### mamelon mâle / mâle conique

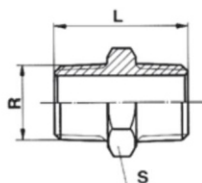

| CODE      | R   | S  | L  |
|-----------|-----|----|----|
| 220 088 X | 1/8 | 12 | 22 |
| 220 044 X | 1/4 | 14 | 24 |
| 220 033 X | 3/8 | 19 | 28 |
| 220 022 X | 1/2 | 22 | 34 |
| 220 011 X | 3/4 | 30 | 40 |
| 220 000 X | 1"  | 36 | 46 |

### 222 X



inox  
316 Ti

#### réduction mâle / mâle conique

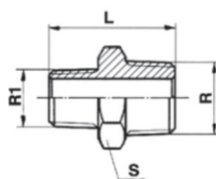

| CODE      | R   | R1  | S  | L    |
|-----------|-----|-----|----|------|
| 222 084 X | 1/4 | 1/8 | 14 | 25,0 |
| 222 083 X | 3/8 | 1/8 | 19 | 25,5 |
| 222 043 X | 3/8 | 1/4 | 19 | 29   |
| 222 042 X | 1/2 | 1/4 | 22 | 33,0 |
| 222 032 X | 1/2 | 3/8 | 22 | 33,5 |
| 222 021 X | 3/4 | 1/2 | 30 | 40,5 |
| 222 010 X | 1"  | 3/4 | 36 | 45,5 |

### 228 X



inox  
316 Ti

#### réduction mâle conique / femelle

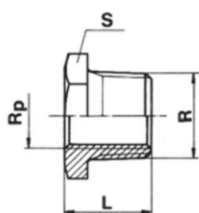

| CODE      | R   | Rp  | S  | L    |
|-----------|-----|-----|----|------|
| 228 048 X | 1/4 | 1/8 | 14 | 17,0 |
| 228 038 X | 3/8 | 1/8 | 19 | 17,5 |
| 228 034 X | 3/8 | 1/4 | 19 | 17,5 |
| 228 024 X | 1/2 | 1/4 | 22 | 21,0 |
| 228 023 X | 1/2 | 3/8 | 22 | 21,0 |
| 228 012 X | 3/4 | 1/2 | 30 | 24,5 |

### 224 X



inox  
316 L

#### réduction femelle / mâle conique

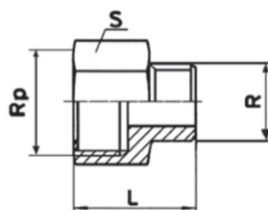

| CODE      | R   | Rp  | S  | L  |
|-----------|-----|-----|----|----|
| 224 048 X | 1/8 | 1/4 | 17 | 25 |
| 224 034 X | 1/4 | 3/8 | 21 | 28 |
| 224 024 X | 1/4 | 1/2 | 24 | 30 |
| 224 023 X | 3/8 | 1/2 | 24 | 30 |
| 224 012 X | 1/2 | 3/4 | 30 | 36 |

### 268 X



inox  
316 Ti

#### traversée de cloison femelle / femelle

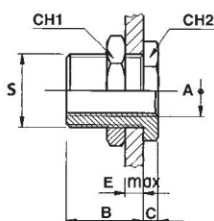

| CODE      | A   | B  | C | E <sub>max</sub> | S       | ø perç | CH1 | CH2 |
|-----------|-----|----|---|------------------|---------|--------|-----|-----|
| 268 088 X | 1/8 | 14 | 4 | 10               | M16x1,5 | 17     | 22  | 19  |
| 268 044 X | 1/4 | 21 | 4 | 16               | M20x1,5 | 21     | 27  | 24  |
| 268 033 X | 3/8 | 21 | 5 | 17               | M26x1,5 | 27     | 32  | 30  |
| 268 022 X | 1/2 | 27 | 6 | 20               | M28x1,5 | 37     | 36  | 32  |

## Accessoires en acier inoxydable

### 320 X



inox  
316 Ti

#### manchon femelle / femelle cylindrique

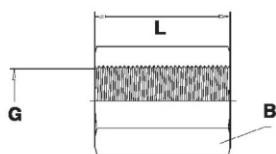

| CODE      | G   | B  | L  |
|-----------|-----|----|----|
| 320 088 X | 1/8 | 14 | 20 |
| 320 044 X | 1/4 | 17 | 28 |
| 320 033 X | 3/8 | 22 | 28 |
| 320 022 X | 1/2 | 27 | 32 |
| 320 011 X | 3/4 | 32 | 36 |
| 320 000 X | 1"  | 41 | 40 |

### 331 X



inox  
316 L

#### réduction femelle / femelle cylindrique

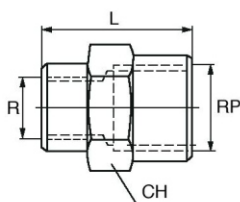

| CODE      | Rp  | R   | L    | CH |
|-----------|-----|-----|------|----|
| 331 048 X | 1/4 | 1/8 | 23   | 17 |
| 331 034 X | 3/8 | 1/4 | 27   | 22 |
| 331 024 X | 1/2 | 1/4 | 30   | 27 |
| 331 023 X | 1/2 | 3/8 | 27,5 | 24 |
| 331 012 X | 3/4 | 1/2 | 30   | 30 |

### 420 X



inox  
316

#### T égal, femelle cylindrique

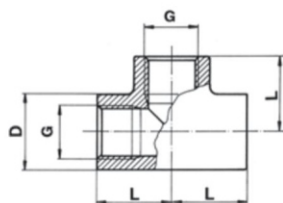

| CODE      | G   | D    | L  |
|-----------|-----|------|----|
| 420 088 X | 1/8 | 14   | 16 |
| 420 044 X | 1/4 | 18   | 21 |
| 420 033 X | 3/8 | 22   | 25 |
| 420 022 X | 1/2 | 27   | 28 |
| 420 011 X | 3/4 | 33,5 | 33 |

### 521 X



inox  
316

#### L égal, femelle cylindrique

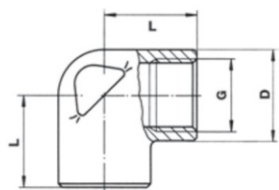

| CODE      | G   | D    | L  |
|-----------|-----|------|----|
| 521 088 X | 1/8 | 14   | 16 |
| 521 044 X | 1/4 | 18   | 21 |
| 521 033 X | 3/8 | 22   | 25 |
| 521 022 X | 1/2 | 27   | 28 |
| 521 011 X | 3/4 | 33,5 | 33 |

### 522 X



inox  
316

#### L mâle conique, femelle cylindrique

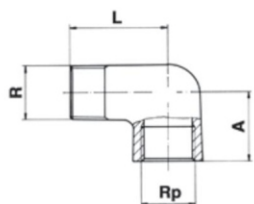

| CODE      | Rp  | R   | L  | A  |
|-----------|-----|-----|----|----|
| 522 088 X | 1/8 | 1/8 | 26 | 20 |
| 522 044 X | 1/4 | 1/4 | 30 | 20 |
| 522 033 X | 3/8 | 3/8 | 36 | 24 |
| 522 022 X | 1/2 | 1/2 | 41 | 28 |
| 522 011 X | 3/4 | 3/4 | 48 | 34 |

## Accessoires en acier inoxydable

### 282 X



inox  
316 Ti

#### bouchon mâle conique, avec 6 pans creux

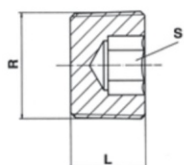

| CODE      | R   | S  | L  |
|-----------|-----|----|----|
| 282 088 X | 1/8 | 5  | 8  |
| 282 044 X | 1/4 | 7  | 10 |
| 282 033 X | 3/8 | 8  | 10 |
| 282 022 X | 1/2 | 10 | 10 |
| 282 011 X | 3/4 | 12 | 12 |

### 252 X



inox  
316 Ti

#### bouchon mâle cylindrique, avec joint Viton monté et 6 pans

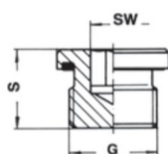

| CODE      | G   | SW | S  |
|-----------|-----|----|----|
| 252 088 X | 1/8 | 5  | 12 |
| 252 044 X | 1/4 | 6  | 17 |
| 252 033 X | 3/8 | 8  | 17 |
| 252 022 X | 1/2 | 10 | 19 |
| 252 011 X | 3/4 | 12 | 21 |

### 322 X



inox  
316 Ti

#### bouchon mâle conique

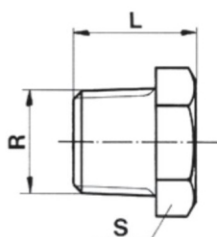

| CODE      | R   | L  | S  |
|-----------|-----|----|----|
| 322 088 X | 1/8 | 13 | 12 |
| 322 044 X | 1/4 | 17 | 14 |
| 322 033 X | 3/8 | 17 | 19 |
| 322 022 X | 1/2 | 21 | 22 |
| 322 011 X | 3/4 | 24 | 30 |

### 323 X



inox  
316 Ti

#### bouchon femelle

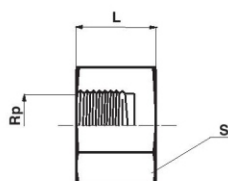

| CODE      | Rp  | L  | S  |
|-----------|-----|----|----|
| 323 088 X | 1/8 | 13 | 14 |
| 323 044 X | 1/4 | 17 | 19 |
| 323 033 X | 3/8 | 18 | 22 |
| 323 022 X | 1/2 | 22 | 27 |
| 323 011 X | 3/4 | 24 | 32 |

## Accessoires en acier inoxydable

### 324 X



#### douille cannelée, mâle conique

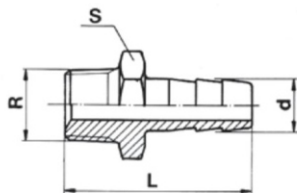

| CODE      | R   | d    | L  | S  |
|-----------|-----|------|----|----|
| 324 084 X | 1/8 | 5    | 30 | 12 |
| 324 086 X | 1/8 | 7    | 30 | 12 |
| 324 046 X | 1/4 | 7    | 40 | 14 |
| 324 048 X | 1/4 | 9    | 40 | 14 |
| 324 041 X | 1/4 | 10   | 40 | 14 |
| 324 042 X | 1/4 | 12   | 42 | 14 |
| 324 038 X | 3/8 | 9    | 42 | 19 |
| 324 031 X | 3/8 | 10   | 42 | 19 |
| 324 033 X | 3/8 | 12   | 45 | 19 |
| 324 032 X | 3/8 | 14,5 | 45 | 19 |
| 324 020 X | 1/2 | 10   | 45 | 22 |
| 324 021 X | 1/2 | 12   | 45 | 22 |
| 324 022 X | 1/2 | 14,5 | 50 | 22 |
| 324 015 X | 3/4 | 17,5 | 55 | 27 |
| 324 017 X | 3/4 | 20,5 | 55 | 27 |

### 335 XL



#### raccord 3 pièces femelle / mâle conique

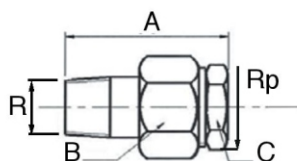

| CODE       | R/Rp | A  | B  | C  |
|------------|------|----|----|----|
| 335 044 XL | 1/4  | 37 | 22 | 17 |
| 335 033 XL | 3/8  | 42 | 26 | 22 |
| 335 022 XL | 1/2  | 48 | 30 | 27 |
| 335 011 XL | 3/4  | 58 | 36 | 30 |

### 336 XL



#### raccord 3 pièces mâle / mâle conique

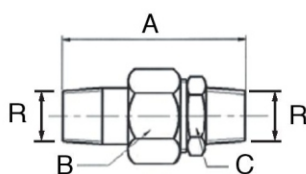

| CODE       | R   | A  | B  | C  |
|------------|-----|----|----|----|
| 336 044 XL | 1/4 | 47 | 22 | 17 |
| 336 033 XL | 3/8 | 54 | 26 | 22 |
| 336 022 XL | 1/2 | 60 | 30 | 27 |
| 336 011 XL | 3/4 | 71 | 36 | 27 |

### 337 XL



#### raccord 3 pièces femelle / femelle

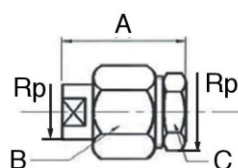

| CODE       | Rp  | A  | B  | C  |
|------------|-----|----|----|----|
| 337 044 XL | 1/4 | 30 | 22 | 17 |
| 337 033 XL | 3/8 | 35 | 26 | 22 |
| 337 022 XL | 1/2 | 39 | 30 | 27 |
| 337 011 XL | 3/4 | 48 | 36 | 27 |