

# R0 - F950 - Orifice miniature calibré en saphir, de précision, pour air et gaz neutres, corps en plastique, raccordement cannelé, avec ou sans filtre incorporé

Precision Restrictor R-0	
<b>Description</b>	Precision sapphire restrictor for reducing the flow compressed air or non-corrosive gases
<b>Medium</b>	Flow <b>Tolerance</b> ± 0.005 mm respectively ± 3% of volume flow
<b>Filter element</b>	5 µm for DN0.08 up to DN0.23, from DN0.25 on 100 µm
<b>Operating pressure</b>	vacuum up to max. 7 bar <b>Temperature range</b> 5 °C to 50 °C / 41 °F to 122 °F
<b>Material</b>	Body: polycarbonate, FDA-approved Restrictor: polycarbonate Filter element: stainless steel fabric
Restrictor with Filter F950	
<b>Description</b>	Disposable in-line-filter with Dutch weave screen of 304 stainless steel. Flow direction and filter size in µm are clearly marked. The colour indicates the nominal size.
<b>Diameter tolerance</b>	-3% to +10% of nominal diameter
<b>Filter element</b>	5 µm at DN 0.10 to DN 0.15, 43 µm at DN 0.18 to DN 0.41, 73 µm at DN 0.51 to DN 0.76
<b>Operating pressure</b>	max. 7 bar <b>Temperature range</b> 5 °C to 50 °C / 41 °F to 122 °F
<b>Material</b>	Body: polysulphone Restrictor: sapphire Filter element: stainless steel fabric

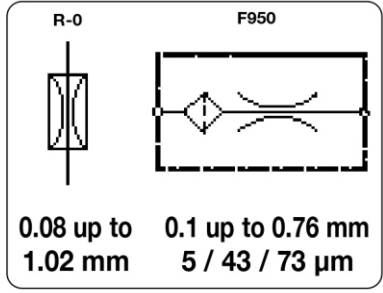

Dimensions	Connection	Nominal size	Order	Nominal size	Order
A	inlet / outlet	colour / DN	number	colour / DN	number
mm		Ø mm		Ø mm	

## Restrictor, barbed fittings Ø 2.7

30 fittings Ø 2.7		operating pressure max 7 bar		R-0...-6	
gold	0.08	R-003-6	orange	0.36	R-014-6
purple	0.10	R-004-6	grey	0.41	R-016-6
white	0.13	R-005-6	brown	0.43	R-017-6
yellow	0.18	R-007-6	red	0.48	R-019-6
light green	0.20	R-008-6	dark blue	0.51	R-020-6
lavender	0.23	R-009-6	black	0.64	R-025-6
light blue	0.25	R-010-6	beige	0.76	R-030-6
green	0.30	R-012-6	dark grey	0.89	R-035-6
			cyan	1.02	R-040-6

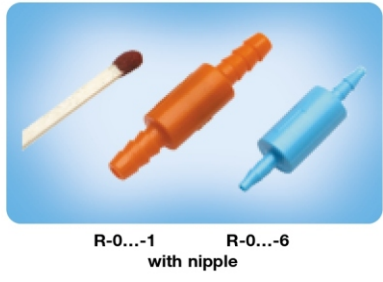

## Restrictor, barbed fittings Ø 4,7

34 fittings Ø 4.7		operating pressure max 7 bar		R-0...-1	
gold	0.08	R-003-1	orange	0.36	R-014-1
purple	0.10	R-004-1	grey	0.41	R-016-1
white	0.13	R-005-1	brown	0.43	R-017-1
yellow	0.18	R-007-1	red	0.48	R-019-1
light green	0.20	R-008-1	dark blue	0.51	R-020-1
lavender	0.23	R-009-1	black	0.64	R-025-1
light blue	0.25	R-010-1	beige	0.76	R-030-1
green	0.30	R-012-1	dark grey	0.89	R-035-1
			cyan	1.02	R-040-1



## Restrictor with filter

34 fittings Ø 2.7		operating pressure max. 7 bar		F950	
nipple Ø 2.7 mm, 5/43/73 µm					
purple	0.10	5 µm	F950- 5-041-B80		
light green	0.13	5 µm	F950- 5-050-B80		
red	0.15	5 µm	F950- 5-051-B80		
cyan	0.18	43 µm	F950-43-071-B80		
yellow	0.25	43 µm	F950-43-101-B80		
black	0.30	43 µm	F950-43-121-B80		
grey	0.41	43 µm	F950-43-161-B80		
blue	0.51	73 µm	F950-73-201-B80		
brown	0.64	73 µm	F950-73-251-B80		
beige	0.76	73 µm	F950-73-301-B80		



## Special options, add the appropriate letter

plain fittings Ø 2.3	A = 9,9 mm		for R-0	R-0...-0
nipple Ø 4.7	A = 34 mm		for F950	F950-...-...-B85

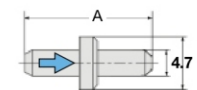

plain fittings R-0...-0

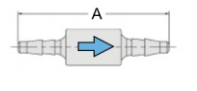

barbed fittings Ø 2.7 R-0...-6 F950-...-...-B80

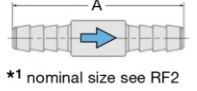

barbed fittings Ø 4.7 R-0...-1 F950-...-...-B85

\*1 nominal size see RF2

