

CARACTÉRISTIQUES TECHNIQUES

Matériaux et composants

- corps en aluminium anodisé
- filet en laiton nickelé
- filetage : mâle BSP cylindrique (coupleurs et embouts laiton)
mâle BSP conique (embouts acier)
femelle BSP cylindrique

Champ d'application : air comprimé



- Ensemble connecté



- Pression sur le bouton pour assurer la décompression



- Seconde pression pour désaccoupler



- Déconnexion

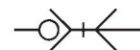

Séries SN20 / SN60 / SN90

- 1 - Corps: Aluminium
- 2 - Bouton, Clapet et Bague d'échappement: Acier trempé et zingué
- 3 - Filet: Laiton nickelé UNI EN 12164 CW614N
- 4 - Ressorts: Acier Inox AISI 302
- 5 - Billes: Acier Inox AISI 420
- 6 - Joint d'étanchéité NBR

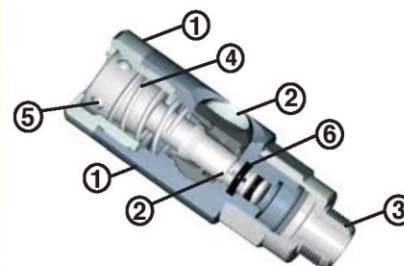

Coupleurs de sécurité, série SN 20.8, selon la norme ISO 4414
Profil ISO 6150 B-15 - Passage de 8 mm

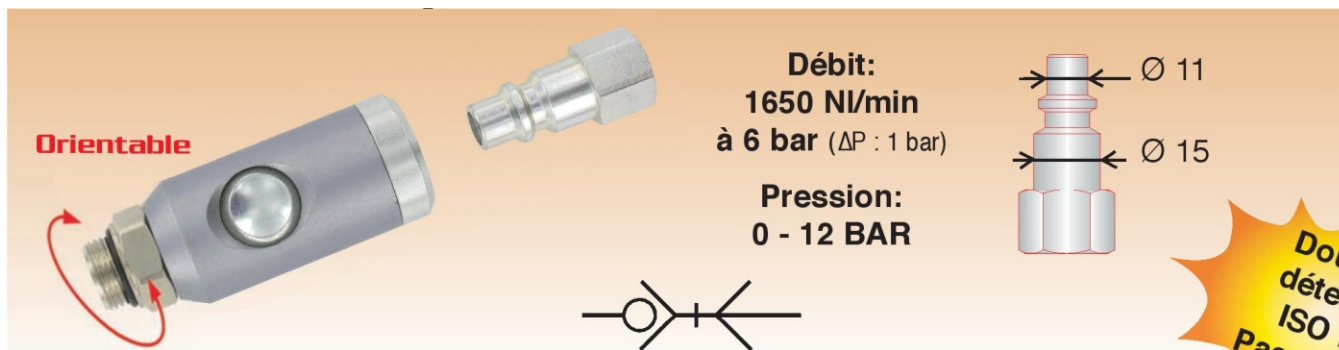

SN 21.8

implantation mâle BSP cylindrique avec joint monté

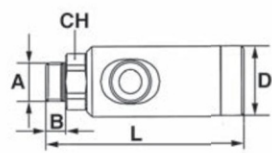
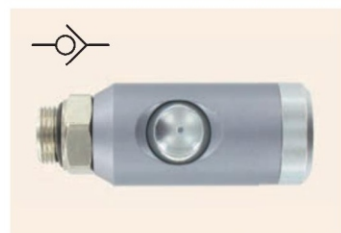

CODE	A	B	D	L	CH	DN
SN21 833	3/8	7	29	75	21	8
SN21 822	1/2	8,5	29	78	25	8

SN 22.8

implantation femelle BSP cylindrique

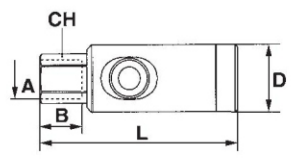

CODE	A	B	D	L	CH	DN
SN22 833	3/8	10	29	81	21	8
SN22 822	1/2	11	29	83	24	8

SN 25.8

équipé d'une douille cannelée

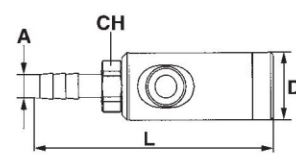
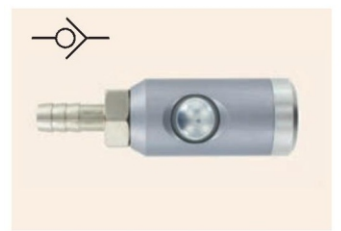

CODE	Ø tube	A	D	L	CH	DN
SN25 808	8	9	29	94	21	8
SN25 810	10	11	29	94	21	8
SN25 813	13	14	29	94	21	8

SN 821

distributeur à 2 voies, implantation mâle BSP conique

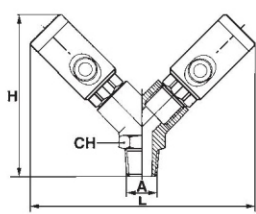
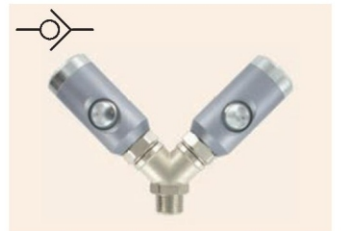

CODE	A	H	L	CH	DN
SN821 44	1/4	98	154	17	8
SN821 33	3/8	102	159	20	8
SN821 22	1/2	113	171	25	8

SN 822

distributeur à 2 voies, implantation femelle BSP cylindrique

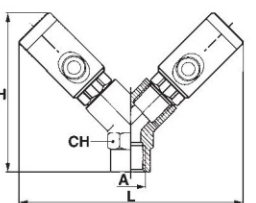

CODE	A	H	L	CH	DN
SN822 44	1/4	98	158	17	8
SN822 33	3/8	102	163	20	8
SN822 22	1/2	113	175	25	8

embouts en laiton nickelé - passage 8 mm

231

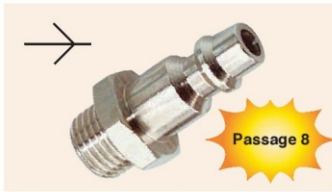

Passage 8

embout mâle cylindrique

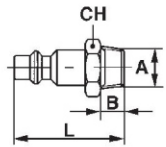

CODE	A	B	L	CH
231 833	3/8	9	40	19
231 822	1/2	10	42	24

232



Passage 8

embout femelle cylindrique

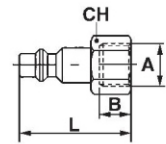

CODE	A	B	L	CH
232 833	3/8	11,5	40	20
232 822	1/2	14	42	24

235



Passage 8

embout avec douille cannelée

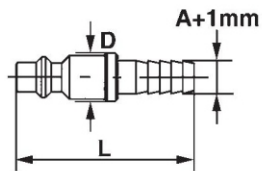

CODE	A	D	CH
235 808	8	15	45
235 810	10	15	46
235 812	12	15	48,5

embouts en acier traité - passage 8 mm

S21

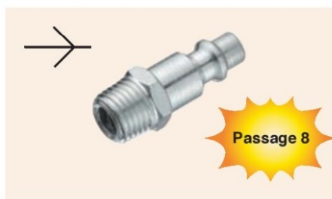

Passage 8

embout mâle conique

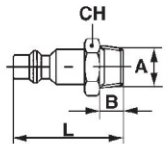

CODE	A	B	L	CH
S21 804	1/4	11	43,5	17
S21 803	3/8	11,5	44	17
S21 802	1/2	14	46,5	22

S22



Passage 8

embout femelle cylindrique

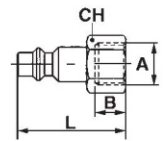

CODE	A	B	L	CH
S22 804	1/4	10	40,5	17
S22 803	3/8	11	42,5	20
S22 802	1/2	11	44,5	24

S29

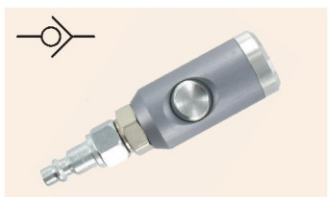

réduction passage 8 mm - sortie coupleur 5,5 mm

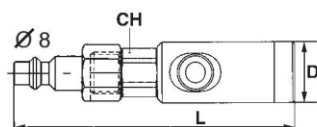

CODE	D	L	CH
S29 806	25	90	20