

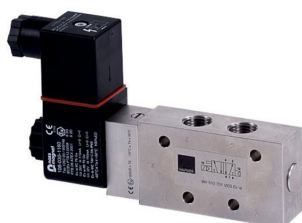



Distributeurs pneumatiques ATEX pour ambiances explosibles EEx ia - Corps INOX 316L - Plage de température standard

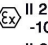

Material: Stainless steel, 316L 
 Zone: 1, 2, 21, 22
 Temperature range: -10°C ... +50°C
 Ignition protection type: Ex ia (intrinsically safe)
 Temperature class: T6

Marking on valve   II 2 G Ex h IIC T6 Gb
 -10°C ≤ Ta ≤ +50°C
  II 2 D Ex h IIC T80°C
 Db -10°C ≤ Ta ≤ +50°C

Please note:
 Maximum operating pressure for valves with Ex ia solenoid system is 8 bar!

Coil is 30 mm wide!

The following solenoid valves are available:



Type	Function	Port size	Installation
MH 311 015 VES Ex ia	3/2-way direct acting	G 1/8"	in-line
MH 310 701 VES Ex ia	3/2-way, single sol.	G 1/4"-1/4" NPT	in-line
MOH 310 701 VES Ex ia	3/2-way, n.o. single sol.	G 1/4"-1/4" NPT	in-line
MH 310 121 VES Ex ia	3/2-way, single sol.	G 1/2"	in-line
MH 320 121 VES Ex ia	3/2-way, double sol.	G 1/2"	in-line
MH 510 701 VES Ex ia	5/2-way, single sol.	G 1/4"-1/4" NPT	in-line
MH 510 121 VES Ex ia	5/2-way, single sol.	G 1/2"-1/2" NPT	in-line
MH 520 701 VES Ex ia	5/2-way, double sol.	G 1/4"-1/4" NPT	in-line
MH 520 121 VES Ex ia	5/2-way, double sol.	G 1/2"-1/2" NPT	in-line
MH 53_ 701 VES Ex ia	5/3-way, different versions	G 1/4"-1/4" NPT	in-line
MH 53_ 121 VES Ex ia	5/3-way, different versions	G 1/2"-1/2" NPT	in-line

Valves with interface according to NAMUR-standard			
MNH 350 701 VES Ex ia	3/2-way & 5/2-way	G 1/4"-1/4" NPT	1/4" NAMUR
MNH 310 701 VES Ex ia	3/2-way, single sol.	G 1/4"-1/4" NPT	1/4" NAMUR
MNH 510 701 VES Ex ia	5/2-way, single sol.	G 1/4"-1/4" NPT	1/4" NAMUR
MNH 520 701 VES Ex ia	5/2-way, double sol.	G 1/4"-1/4" NPT	1/4" NAMUR

Delivery contains valve with the appropriate operator system, coil, manual and declaration of conformity.

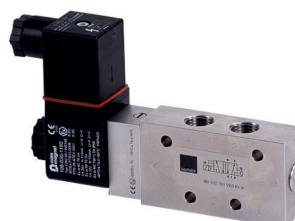
Distributeurs pneumatiques ATEX pour ambiances explosibles EEx ia - Corps INOX 316L - Basse température



Material: Stainless steel, 316L 
 Zone: 1, 2, 21, 22
 Temperature range: -40°C ... +50°C 
 Ignition protection type: Ex ia (intrinsically safe)
 Temperature class: T6

Marking on valve   II 2 G Ex h IIC T6 Gb
 -40°C ≤ Ta ≤ +50°C
  II 2 D Ex h IIC T80°C
 Db -40°C ≤ Ta ≤ +50°C

Please note:
 Maximum operating pressure for valves with Ex ia solenoid system is 8 bar!

Coil is 30 mm wide!

The following solenoid valves are available:

Type	Function	Port size	Installation
MH 311 015 VES TT Ex ia	3/2-way direct acting	G 1/8"	in-line
MH 310 701 VES TT Ex ia	3/2-way, single sol.	G 1/4" - 1/4" NPT	in-line
MOH 310 701 VES TT Ex ia	3/2-way, n.o. single sol.	G 1/4" - 1/4" NPT	in-line
MH 510 701 VES TT Ex ia	5/2-way, single sol.	G 1/4" - 1/4" NPT	in-line
MH 520 701 VES TT Ex ia	5/2-way, double sol.	G 1/4" - 1/4" NPT	in-line
MH 53_701 VES TT Ex ia	5/3-way, different versions	G 1/4" - 1/4" NPT	in-line
Valves with interface according to NAMUR-standard			
MNH 350 701 VES TT Ex ia	3/2-way & 5/2-way	G 1/4" - 1/4" NPT	1/4" NAMUR
MNH 310 701 VES TT Ex ia	3/2-way, single sol.	G 1/4" - 1/4" NPT	1/4" NAMUR
MNH 510 701 VES TT Ex ia	5/2-way, single sol.	G 1/4" - 1/4" NPT	1/4" NAMUR
MNH 520 701 VES TT Ex ia	5/2-way, double sol.	G 1/4" - 1/4" NPT	1/4" NAMUR

Delivery contains valve with the appropriate operator system, coil, manual and declaration of conformity.

MA 30 EEx ia tD II CT6 24DC



When this solenoid system is used in combination with „ATEX certified“ mechanical components conforming EN 13463-1:2001 and PrEN 13463-5:2000, the entire valve can be used in explosive hazardous environment zone 1, 2, 21, and 22.

ATEX approved intrinsic safety coil and connector for gas and dust explosion-hazardous environment. System is also IEC-Ex approved. Electrical connection according to DIN EN 175301-803-A / ISO 4400.

Coil:
 Electrical characteristics: 21,6... 28 V DC
 >37 mA
 final temperature rise 18 K
 275 Ohm +/- 8 %

Relative duty cycle: 100 %

Temperature range: -40°... +50° C

Insulation class of insulating materials according to DIN VDE 0580: F

Protection level with connector according to EN 60529: IP 65

Moulding material: Thermoset resin (Epoxy)

Marking on coil: II 2G Ex ia IIB/IIC T6
 II 2D Ex tb IIIC T80°C

Barrier:
 Electrical characteristics: 21,6... 28 V DC
 Admissible peak value: 28 V DC
 115 mA
 1,6 W

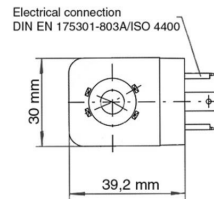
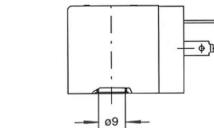

MA 30 EEx ia tD II CT6 24DC

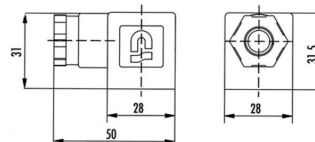

ST 30 Ex ia

Order Code: MA 30 EEx ia tD II CT6 24DC

As the coil is 30 mm wide, a spacer plate called „ZPN 5“ has to be used, in case of combination with our NAMUR-valve series 700 refer to page 2.10.12.

ST 30 Ex ia is an ATEX approved connector, especially designed for being used in combination with the intrinsic safety coil. For dust approval (zone 21), this original connector is mandatory. Delivery includes connector ST 30 Ex ia, flat nitril gasket and fixing screw (zinc-plated steel). Form according to A - ISO 4400, no LED, no varistor, operating voltage 0 – 250 V, max. current 10 A, cable diameter 6 – 8 mm.

How to select a suitable barrier:
 I/U Characteristics supply units/solenoid coil

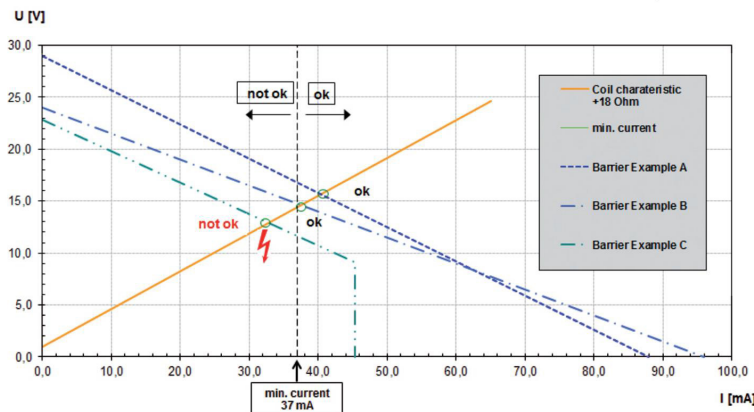

The ATEX approval is only valid as long as the associated components are used.

Connecteur électrique - Pour ambiances explosibles (ATEX) - Compatible avec bobines ST22 / ST30 EEx ia et EEx nA

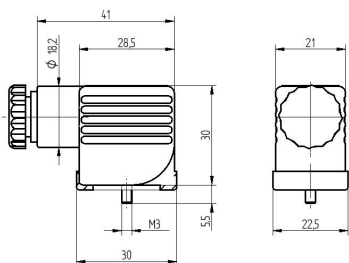
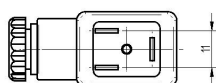

ST 22 Ex

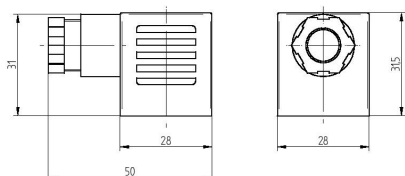
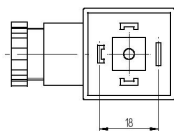

ST 30 Ex ia / ST 30 Ex nA



Connectors as accessories for explosion-proof coils.

Type ST 22 Ex

Connector to be used in combination with MA 22 Ex nA. Connector is classified for zone 2 and 22 cat. IIG/D. Includes flat seal.

Type ST 30 Ex ia

Connector which is to be used in combination with the coil type MA 30 Ex ia tD II CT6 24DC. Connector has no separate ATEX certification. Connector is classified for zone 21, cat. IID. Can also be used in combination with intrinsically safe coils in zone 1 (cat. IIG). Includes flat silicon seal.

Type ST 30 Ex nA

Connector to be used in combination with MA 30 Ex nA. Connector is classified for zone 2 and 22, cat. IIIG and IID. Includes profiled NBR seal.

Other connectors are available on request.

Type	Form	LED	VAR	Operat. voltage	Max. current	Cable diameter
ST 22 Ex	Industrial	no	no	0 - 250 V	10 A	6 - 8 mm
ST 30 Ex ia	A, ISO 4400	no	no	0 - 250 V	10 A	6 - 8 mm
ST 30 Ex nA	A, ISO 4400	no	no	0 - 250 V	10 A	4 - 8 mm