

Description The pressure transducer converts pneumatic pressure into a proportional electrical signal for use in computers and microprocessors etc. Type D7A is a 2-wire pressure current transducer. Type D7V is a 3-wire pressure voltage transducer.

Operation Pressure to the unit is continuously monitored by a high-performance miniature silicon semi-conductor transducer, and converted to a proportional voltage or current signal.

Media D7 Any non-ionic, non-corrosive media compatible with stainless steel, nylon, silicone and epoxy

Media D8 Compressed air, oxygen, helium ... water, oil, kerosine, alcohol, brake fluid, glycerine, nitrogen...

Supply voltage 9 to 32V (D7A) and 12 to 32V (D7V), maximum load current of source: 2 mA

Outlet signal 4 ... 20 mA: power consumption 260 mW 0 ... 10V: power consumption, no load: max. 9.5 mA

Linearity/Hysteresis typ. < 0.2 % FS < 0.5% FS max.

Repeatability typ. < 0.1 % FS < 0.5% FS max.

Temperature effect typ. < 0.02% FS / °C < 0.05% FS / °C max.

Long-term stability typ. < 0.1 % FS

Vibration sensitivity 10g at 5 Hz to 500 Hz

Temperature range -40 °C to 100 °C / -40 °F to 210 °F

Housing 303 stainless steel, 1.4305, D8 with ceramics AL₂O₃

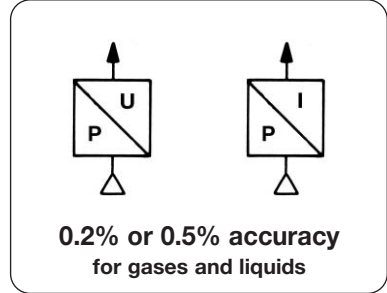

Dimensions		Maximum pressure	Pressure range	Order number with outlet signal	
height	Ø	bar	mbar / bar	4 ... 20 mA	0 ... 10V
mm	mm				

for non-corrosive gases		G ¹ / ₈ , gauge pressure open sensor, with connector	D7A accuracy 0.5%	D7V	
52	22	0.4	0 ... 25 mbar	D7A - B2	D7V - B2
		0.7	-25 ... 25 mbar	D7A - B2V	D7V - B2V
		1	0 ... 70 mbar	D7A - B7	D7V - B7
		1	-70 ... 70 mbar	D7A - B7V	D7V - B7V
		1	0 ... 350 mbar	D7A - C3	D7V - C3
		1	-350 ... 350 mbar	D7A - C3V	D7V - C3V
		1	0 ... 1 bar	D7A - 01	D7V - 01
		1	-1 ... +1 bar	D7A - V1	D7V - V1
		4	0 ... 2 bar	D7A - 02	D7V - 02
		10	0 ... 5 bar	D7A - 05	D7V - 05
		10	0 ... 7 bar	D7A - 07	D7V - 07



for air or water, 0.2%		G ¹ / ₈ , gauge pressure ceramics sensor, with connector	D8A accuracy 0.2%	D8V	
52	22	2	0 ... - 1 bar	D8A - V0	D8V - V0
		2	-1 ... + 1 bar	D8A - V1	D8V - V1
		2	0 ... 1 bar	D8A - 01	D8V - 01
		4	0 ... 2 bar	D8A - 02	D8V - 02
		10	0 ... 5 bar	D8A - 05	D8V - 05
		16	0 ... 10 bar	D8A - 10	D8V - 10
		30	0 ... 16 bar	D8A - 16	D8V - 16
		35	0 ... 20 bar	D8A - 20	D8V - 20
		60	0 ... 35 bar	D8A - 35	D8V - 35
		90	0 ... 50 bar	D8A - 50	D8V - 50
		120	0 ... 70 bar	D8A - 70	D8V - 70
		150	0 ... 100 bar	D8A - 100	D8V - 100



Special options add the appropriate letter

special calibration pressure range indicate on order **XX** D...XX

absolute pressure 1 bar upwards **A** D7...A

absolute pressure for oxygen 1 bar upwards **A** D8...A

thread G¹/₄ max. 40 bar **O** D8...O

thread G³/₈ **F** D...F

angle connector M12x1, aspirator hole 4-pin **G** D...G

angle connector with 2 m cable **KM12-C4-0**

straight connector with 2 m cable **KM12-C4-2**

other cable lengths indicate on order, e.g. 10 m **KM12-A4-2**
KM12-A4-10

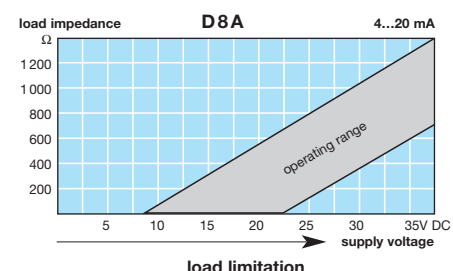
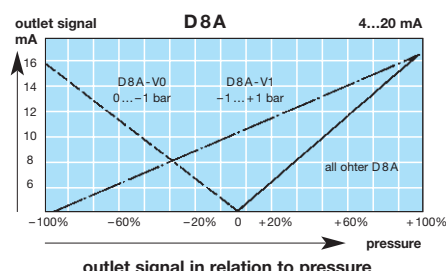
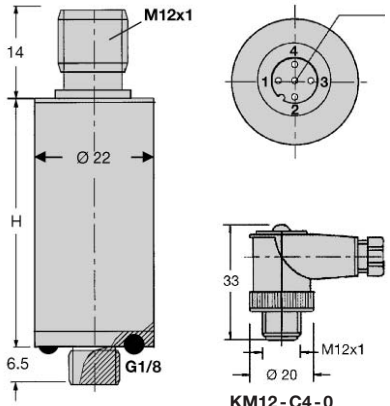
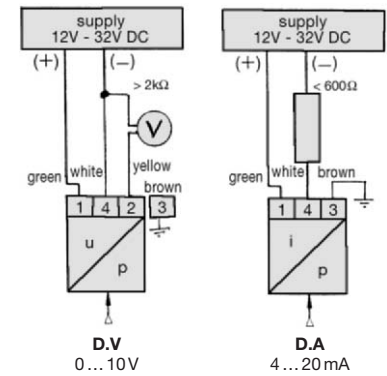

For your information:

1 bar: 14.5 psi	1 l/min: 0.035 scfm	1 mm: 0.039 inch	1 mbar: 0.4 inch H ₂ O	1 mbar: 0.01 m H ₂ O
1 psi: 0.069 bar	1 scfm: 28.3 l/min	1 inch: 25.4 mm	1 inch H ₂ O: 2.5 mbar	1 m H ₂ O: 98 mbar

Order example:
D8A - 10