

Description	Pilot-actuated pressure valve with precisely adjustable pilot setpoint. Perfect for applications which require intrinsic safety, pneumatic sequencing or pressure relief. Valves are normally opened or closed.	
Pressure valve	3-way air-assisted servo valve with exhaust to atmosphere, NO or NC	
	Supply pressure:	1.4 to 8 bar / 20 to 115 psi
	Supply consumption:	0.3 l/min at 2 bar / 30 psi, 0.7 l/min at 7 bar / 100 psi
	Porting:	Ø 4 mm / 5/32 push-in fitting
	Flow rate:	70 l/min at 7 bar / 2.5 cfm at 100 psi, C _v =.06
	Operating speed:	64 ms at 6 bar / 90 psi supply
	Material:	housing: nylon plunger: aluminium seals: NBR other: brass
Effect of supply fluctuation	Pressure switch: < 7 mbar / 0.1 psi increase in pilot switchpoint with 0.7 bar / 10 psi increase in supply Vacuum switch: < 3 mbar / 0.1 Hg increase in pilot switchpoint with 0.3 bar / 5 psi increase in supply	
Repeatability	< ± 2% full scale pilot adjustment	
Temperature range	4 °C to 60 °C / 40 °F to 140 °F	
Materials	Body: polysulfone	Spring: stainless steel
	Diaphragm: polyurethane	Seals: NBR (Buna N)

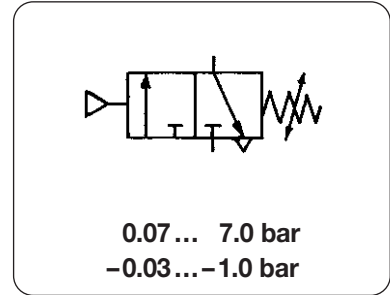

Description	Supply pressure switching valve	Hysteresis typ. mbar	Hysteresis max. mbar	Over-pressure bar	Adjustment range bar	Order number
-------------	---------------------------------	----------------------	----------------------	-------------------	----------------------	--------------

Switch with pneumatic outlet, NO		1/8" NPT		PP / VP700			
	pressure switch	1.4 ... 8 bar	10	30	2	0.07 ... 0.35	PP700- 5PT
			20	40	4	0.07 ... 1.0	PP700- 15PT
			20	70	4	0.07 ... 2.1	PP700- 30PT
			30	140	8	0.20 ... 4.2	PP700- 60PT
			50	200	8	0.35 ... 7.0	PP700-100PT
	vacuum switch	1.4 ... 8 bar	15	30	-1	-0.03 ... -0.17	VP700- 5PT
			20	40	-1	-0.03 ... -0.35	VP700- 10PT
			30	70	-1	-0.07 ... -0.85	VP700- 30PT



PP700-...PT

Switch with pneumatic outlet, NC		1/8" NPT		PP / VP701			
	pressure switch	1.4 ... 8 bar	10	30	2	0.07 ... 0.35	PP701- 5PT
			20	40	4	0.07 ... 1.0	PP701- 15PT
			20	70	4	0.07 ... 2.1	PP701- 30PT
			30	140	8	0.20 ... 4.2	PP701- 60PT
			50	200	8	0.35 ... 7.0	PP701-100PT
	vacuum switch	1.4 ... 8 bar	15	30	-1	-0.03 ... -0.17	VP701- 5PT
			20	40	-1	-0.03 ... -0.35	VP701- 10PT
			30	70	-1	-0.07 ... -0.85	VP701- 30PT



PP700-...PM

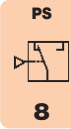

Special options add the appropriate letter

flush mounting	nylon nipple, Ø 1/16", Ø 2, standard	FM	PP700- ... FM
panel mounting	nylon nipple, Ø 1/16", Ø 2, standard	PM	PP700- ... PM
manifold mounting		MM	PP700- ... MM
barbed fitting	nylon, Ø 1/16", Ø 2, only PM or FM	B80	PP700- ... B80
	nylon, Ø 1/8", Ø 4, only PM or FM	B85	PP700- ... B85
	PSU, Ø 1/16", Ø 2, only PM or FM	P80	PP700- ... P80
	PSU, Ø 1/8", Ø 4, only PM or FM	P85	PP700- ... P85

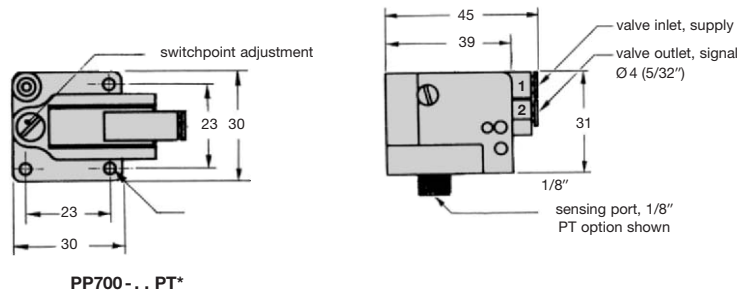

*1 NC means no outlet signal is available if there is no pressure or vacuum at the measuring port.

* For dimensions of other options, please see type F4200

For your information:	1 bar: 14.5 psi	1 l/min: 0.035 scfm	1 mm: 0.039 inch	1 mbar: 0.4 inch H ₂ O	1 mbar: 0.01 m H ₂ O
	1 psi: 0.069 bar	1 scfm: 28.3 l/min	1 inch: 25.4 mm	1 inch H ₂ O: 2.5 mbar	1 m H ₂ O: 98 mbar



Order example:
PP700-100PT