

<b>Description</b>	Standard-type mist lubricator of modular design with exchangeable insert kits. Can be connected to a filter or regulator without the need for double nipples. A bypass valve and venturi nozzle guarantee low pressure drop and uniform lubrication of the compressed air. All "maxi" instruments are easy to take out of fixed piping by simply removing the two fastening bolts on the insert kits.		
<b>Bowl</b>	Metal bowl with sight glass, of 30 cl capacity. Oil refilling under pressure possible. A red ball in the sight glass indicates the oil level.		
<b>Oil mist lubrication</b>	In flow rate range of 60 l/min to 7300 l/min		
<b>Supply pressure</b>	max. 17 bar in metal bowl with sight glass		
<b>Temperature range</b>	-30 °C to 70 °C / -20 °F to 160 °F in metal bowl with sight glass		
<b>Material</b>	Housing and metal bowl: zinc die-casting	Sight glass: polyurethane	Setting knob: acetylene

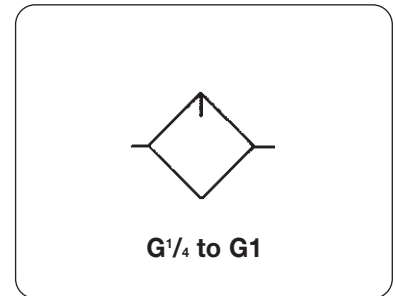

Dimensions			Bowl volume cl	Flow rate		Connection thread G	Order number
A	B	C		m <sup>3</sup> /h*	l/min*		
mm	mm	mm					

"Maxi" compressed air lubricator				metal bowl with sight glass		L20	
89	216	175	30	110	1 800	G <sup>1/4</sup>	L20-02W
89	216	175	30	190	3 100	G <sup>3/8</sup>	L20-03W
89	216	175	30	340	5 600	G <sup>1/2</sup>	L20-04W
111	216	175	30	420	7 000	G <sup>3/4</sup>	L20-06W
111	216	175	30	440	7 300	G1	L20-08W



## Special options add the appropriate letter Accessories

<b>NPT thread</b>		<b>N</b>	L20-0.WN
<b>set of mounting brackets</b>	MK 20-0100	<b>Y</b>	L20-0.WY
<b>insert kit</b>	with bolts and O-rings	G <sup>1/4</sup>	<b>IK 20Y</b>
	with bolts and O-rings	G <sup>1/2</sup>	<b>IK 20A</b>
	with bolts and O-rings		G <sup>3/8</sup> <b>IK 20X</b>
		G <sup>3/4</sup>	<b>IK 20B</b>
<b>connection kit</b>	for connecting 2 instruments	G1	<b>IK 20C</b>
<b>porting block</b>	G <sup>1/4</sup> , for unlubricated compressed air		<b>IK 20CC</b>
<b>switch-on valve</b>	lockable 3/2-way valve		<b>IK 20CP</b>
			<b>IK 20V</b>

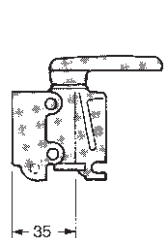
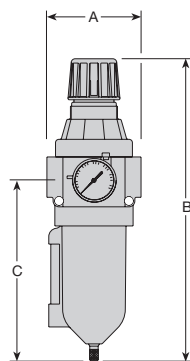

switch-on valve **IK 20V**

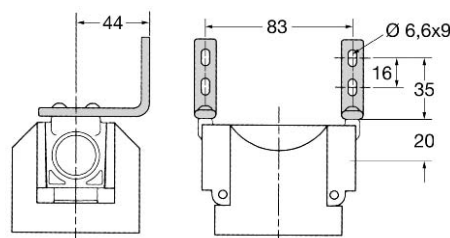

set of mounting brackets **MK 20-0100**

\* at 7 bar supply pressure and 0.3 bar pressure drop

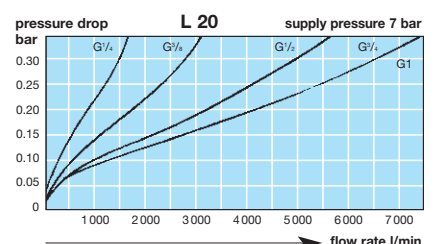

<b>For your information:</b>	1 bar: 14.5 psi	1 l/min: 0.035 scfm	1 mm: 0.039 inch
	1 psi: 0.069 bar	1 scfm: 28.3 l/min	1 inch: 25.4 mm

**Order example:**  
**L20-02W**