

Pre-filter V		Universal filter Z	
Efficiency	99.99% based on 3 µm particle size	Efficiency	99.9999% based on 1 µm particle size. ≤ 0.5 mg/m ³ residual oil content at 7 bar and 20 °C
Filter element	Cellulose-acetate fabric, folded in star shape. Inner and outer supports of stainless steel. Flow from outside to inside.	Filter element	Of borsilicate fibre A 901 with stainless steel jacket and foam protection. High volume glass-fibre bed achieves coalescing effect.
Service life	Star-form folding of the filter fabric increases surface area by 5 times, achieving long service life.	Service life	The filter is pleated for exceptionally long service life. This enables many more solid particles to be collected than is usually possible with low differential pressure.
Temperature	1 °C to 80 °C / 34 °F to 180 °F	Cleaning	The quality of the filtered compressed air remains constant, irrespective of the differential pressure. The filter must be changed as from 0.35 bar differential pressure. Filters out oil, water and solid impurities. Resistant to mineral and synthetic oils.
Cleaning	Cleaning required as from 0.35 bar differential pressure. Solid impurities removed by blowing from outside to inside. Oil to be cleaned in soap suds.		
Application	As coarse and dust filter for removing water and solid impurities		

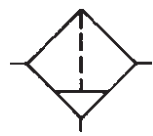

1 µm and 3 µm
0.5 mg/m³ residual oil content
also suitable for vacuum

Dimensions				Order number spare filter	Flow rate m ³ /h* l/min*	Connection thread G	Order number
A	B	C	D				

Pre-filter				including autodrain, max. 16 bar, 99.99% efficiency, ≤ 0.5 mg/m ³ residual oil		3 µm	G.V	
60	167	153	60	1030 V	30	500	G 1/4	G 2V
87	209	188	75	1050 V	50	800	G 1/4	G 3V
87	209	188	90	1070 V	70	1160	G 3/8	G 5V
87	279	258	160	1140 V	100	1660	G 1/2	G 7V
130	315	272	135	2010 V	180	3000	G 3/4	G 9V
130	415	372	235	2020 V	300	5000	G1	G11V
130	515	472	335	2030 V	470	7800	G1 1/2	G12V
130	715	672	525	2050 V	750	11600	G1 1/2	G13V
164	823	775	520	3050 V	940	15600	G2	G14V



G7V

Universal purpose filter				including autodrain, max. 16 bar, 99.9999% efficiency, ≤ 0.5 mg/m ³ residual oil		1 µm	G.Z	
60	167	153	60	1030 Z	30	500	G 1/4	G 2Z
87	209	188	75	1050 Z	50	800	G 1/4	G 3Z
87	209	188	90	1070 Z	70	1160	G 3/8	G 5Z
87	279	258	160	1140 Z	100	1660	G 1/2	G 7Z
130	315	272	135	2010 Z	180	3000	G 3/4	G 9Z
130	415	372	235	2020 Z	300	5000	G1	G11Z
130	515	472	335	2030 Z	470	7800	G1 1/2	G12Z
130	715	672	525	2050 Z	750	11600	G1 1/2	G13Z
164	823	775	520	3050 Z	940	15600	G2	G14Z



G7VD
with differential pressure gauge

Special options add the appropriate letter

Special options	Accessories
differential pressure gauge not for G2	D G...D
manual drain	H G...H
set of mounting brackets BF01 for G2 BF02 for G3 to G 7	X G...X
set of mounting brackets BF03 for G9 to G13	X G...X
"labsfree" for oxygen	L G...L
for painting systems, manual drain clean	O G...O

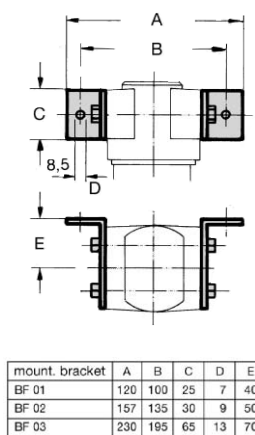
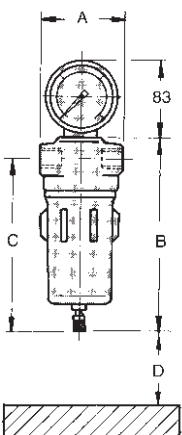

mount. bracket	A	B	C	D	E
BF 01	120	100	25	7	40
BF 02	157	135	30	9	50
BF 03	230	195	65	13	70



Cross-section showing complex construction of micro-filter elements

4-phase filtration

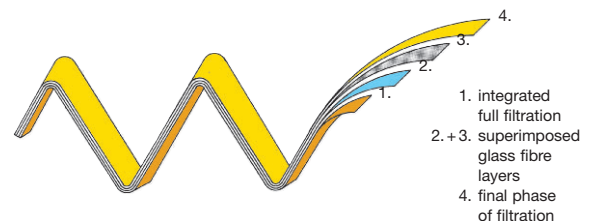

* at 7 bar operating pressure with open outlet. Pressure drop when new: **20 mbar** on the pre-filter and **30 mbar** on the universal filter. The maximum permissible flow rate is 10% higher than the indicated value.

Conversion factor for other operating pressures

operating pressure bar	1	2	3	4	5	6	7	8	9	10	11	12	13	14	15	16
factor	0.25	0.38	0.5	0.65	0.75	0.88	1	1.13	1.25	1.38	1.5	1.63	1.75	1.88	2	2.13

For your information:	1 bar: 14.5 psi	1 l/min: 0.035 scfm	1 mm: 0.039 inch
	1 psi: 0.069 bar	1 scfm: 28.3 l/min	1 inch: 25.4 mm

 **Order example: G12VD**

Filter



11